

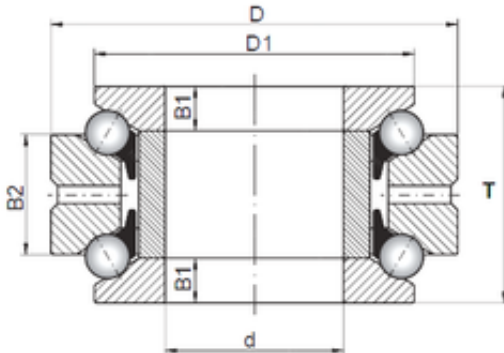

BEARING-SINGAPORE (PTE)LTD.

ISO 234776 thrust ball bearings



Bearing No. 234776

Size	390x560x212 mm
Bore Diameter	390 mm
Outer Diameter	560 mm
Width	212 mm
d	390 mm
D	560 mm
T	212 mm
B1	53 mm
B2	106 mm
D1	499 mm

234776 Bearing 2D drawings and 3D CAD models