

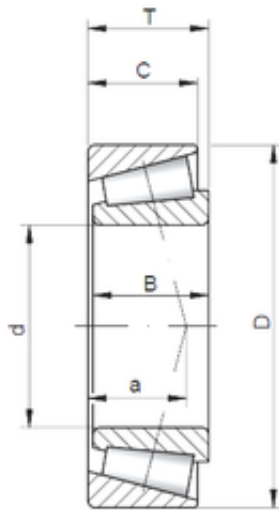

BEARING-SINGAPORE (PTE)LTD.



120,65 mm x 169,862 mm x 26,195 mm ISO
L225842/10 tapered roller bearings

Bearing No. L225842/10

Size	120.65x169.862x25.4 mm
Bore Diameter	120,65 mm
Outer Diameter	169,862 mm
Width	25,4 mm
d	120,65 mm
D	169,862 mm
T	25,4 mm
B	26,195 mm
C	20,638 mm
a	2,5 mm

L225842/10 Bearing 2D drawings and 3D CAD models