

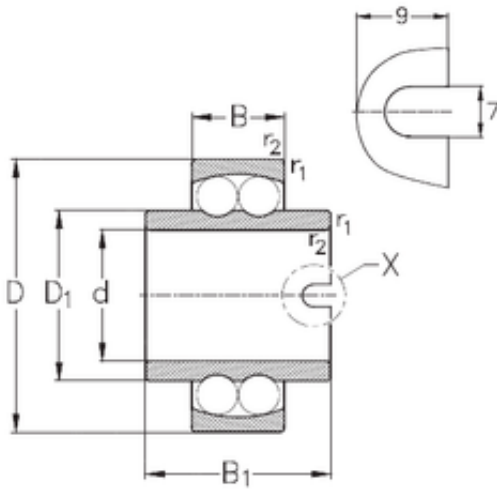

BEARING-SINGAPORE (PTE)LTD.

55 mm x 100 mm x 60 mm NKE 11211 self aligning ball bearings

Bearing No. 11211



11211 Bearing 2D drawings and 3D CAD models

Size	55x100x60 mm
Bore Diameter	55 mm
Outer Diameter	100 mm
Width	60 mm
d	55 mm
D	100 mm
B	60 mm
C	21 mm
r1 min.	1,5 mm
r2 min.	1,5 mm
D1	69,5 mm
Weight	1,13 Kg
Basic dynamic load rating (C)	27,6 kN
Basic static load rating (C0)	10,6 kN