

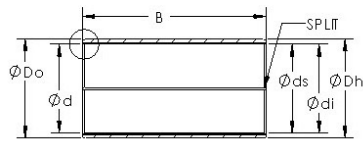

BEARING-SINGAPORE (PTE)LTD.

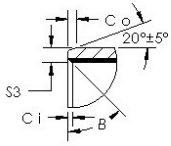

AST AST850SM 1010 plain bearings

Bearing No. AST850SM 1010

Bore Diameter	10 mm
Outer Diameter	12 mm
Bearing Type	metal with bronze and graphite
Shaft Dia., Nominal (d)	10.0000
Shaft Size (ds) - 10 +0 / -0.022	10 +0 / 0.022
Housing Bore Dia. (Dh) - 12 +0.018 / -0	12 +0.018 / 0
Bearing Outside Diameter, Nominal(Do)	12.000
Bearing Bore after Mounting (di)	10 +0.148 / +0.010
Average Clearance (Cd)	0.0900
Wall Thickness (S3)	0.965
Bearing Length, Nominal (B)	10.000
Bearing Length Tolerance (B tol.) - +0 / -0.40	+0 / 0.40
OD Chamfer Length (Co)	0.600
ID Chamfer Angle (B deg.)	35
ID Chamfer Length (Ci)	0.300

AST850SM 1010 Bearing 2D drawings and 3D CAD models