

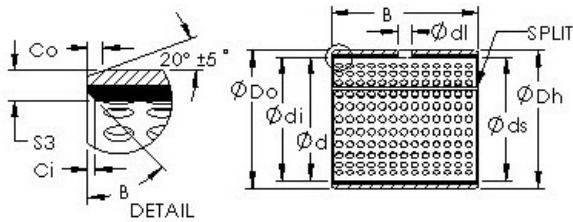

BEARING-SINGAPORE (PTE)LTD.

AST AST20 061B06 plain bearings



Bearing No. AST20 061B06

Bore Diameter	9,525 mm
Outer Diameter	11,9126 mm
Bearing Type	straight
Shaft Dia., Nominal (d)	0.3750
Shaft Size (ds)	0.3648 / 0.3639
Housing Bore Dia. (Dh)	0.4694 / 0.4687
Bearing Outside Diameter, Nominal (Do)	0.469
Bearing Bore after Mounting (di)	0.3694 / 0.3667
Average Clearance (Cd)	0.0040
Wall Thickness (S3)	0.051
Bearing Length, Nominal (B)	0.375
Bearing Length Tolerance (B tol.) - +.010 / -0.010	+0.010 / 0.010
OD Chamfer Length (Co)	0.024
ID Chamfer Angle (B deg.)	30
ID Chamfer Length (Ci)	0.012
Material	Carbon steel shell with POM plastic liner

AST20 061B06 Bearing 2D drawings and 3D CAD models