

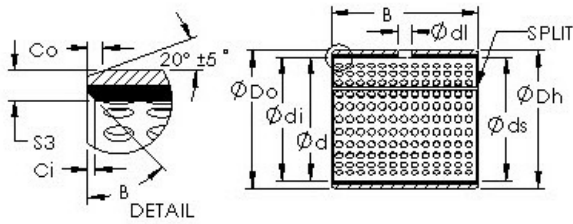

# BEARING-SINGAPORE (PTE)LTD.

## AST AST20 10050 plain bearings



Bearing No. AST20 10050

Bore Diameter	100 mm
Outer Diameter	105 mm
Bearing Type	straight
Shaft Dia., Nominal (d)	100.0000
Shaft Size (ds) - 100 +0 / -0.054	100 +0 / 0.054
Housing Bore Dia. (Dh) - 105 +0.035 / -0	105 +0.035 / 0
Bearing Outside Diameter, Nominal(Do)	105.000
Bearing Outside Diameter Tolerance (Do tol.)	105.120 / 105.070
Bearing Bore after Mounting (di)	100.265 / 100.100
Average Clearance (Cd)	0.2110
Wall Thickness (S3)	2.418
Bearing Length, Nominal (B)	50.000
Bearing Length Tolerance (B tol.) - +0 / -0.40	+0 / 0.40
OD Chamfer Length (Co)	1.800
ID Chamfer Angle (B deg.)	45
ID Chamfer Length (Ci)	0.800
Lube Hole Dia. (dl)	9.500
Material	Carbon steel shell with POM plastic liner

AST20 10050 Bearing 2D drawings and 3D CAD models