

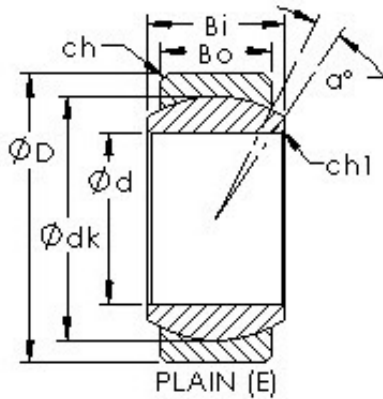

BEARING-SINGAPORE (PTE)LTD.



AST GEG5E plain bearings

Bearing No. GEG5E

Bore Diameter	5 mm
Outer Diameter	16 mm
Bearing Type	plain
Bore Dia (d)	5.0000
Outer Dia (D)	16.0000
Outer Width (Bo)	5.0000
Inner Width (Bi)	9.0000
Dynamic Load Rating (Cr)	5,500
Static Load Rating (Cor)	27,000
Max. shaft corner radius, or 45 deg. chamfer (ch1)	0.300
Max. housing corner radius, or 45 deg. chamfer (ch)	0.300
Spherical Diameter (dk or Dk)	13.000
Mis-alignment Angle (a deg.)	21
Weight (g)	9.00
Material	52100 Chrome steel, or equivalent

GEG5E Bearing 2D drawings and 3D CAD models