

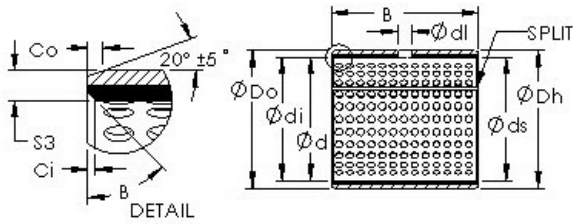

BEARING-SINGAPORE (PTE)LTD.

AST AST20 14IB16 plain bearings



Bearing No. AST20 14IB16

Bore Diameter	22,225 mm
Outer Diameter	25,4 mm
Bearing Type	straight
Shaft Dia., Nominal (d)	0.8750
Shaft Size (ds)	0.8369 / 0.8627
Housing Bore Dia. (Dh)	1.0008 / 1.0000
Bearing Outside Diameter, Nominal (Do)	1.000
Bearing Bore after Mounting (di)	0.8694 / 0.8662
Average Clearance (Cd)	0.0050
Wall Thickness (S3)	0.067
Bearing Length, Nominal (B)	1.000
Bearing Length Tolerance (B tol.) - +.010 / -0.010	+0.010 / 0.010
OD Chamfer Length (Co)	0.028
ID Chamfer Angle (B deg.)	30
ID Chamfer Length (Ci)	0.020
Lube Hole Dia. (dl)	0.250
Material	Carbon steel shell with POM plastic liner

AST20 14IB16 Bearing 2D drawings and 3D CAD models