

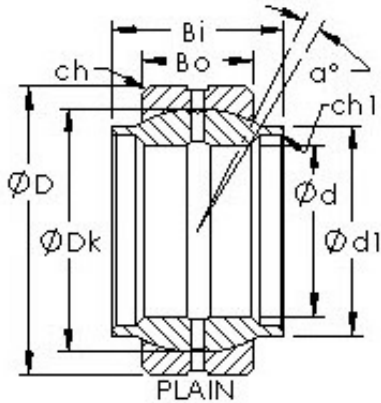

# BEARING-SINGAPORE (PTE)LTD.



## AST GEWZ50ES plain bearings

Bearing No. GEWZ50ES

Bore Diameter	50,8 mm
Outer Diameter	80,9625 mm
Bearing Type	plain
Bore Dia (d)	2.0000
Outer Dia (D)	3.1875
Outer Width (Bo)	1.5000
Inner Width (Bi)	3.0000
Dynamic Load Rating (Cr)	50,354
Static Load Rating (Cor)	150,613
Max. shaft corner radius, or 45 deg. chamfer (ch1)	0.024
Max. housing corner radius, or 45 deg. chamfer (ch)	0.040
Spherical Diameter (dk or Dk)	2.874
Mis-alignment Angle (a deg.)	5
Extended Inner OD (d1)	2.460
Weight (g)	1,110.00
Material	52100 chrome steel, or equivalent

GEWZ50ES Bearing 2D drawings and 3D CAD models