

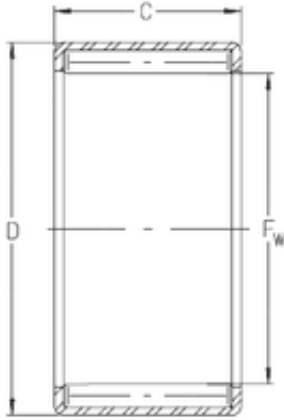

BEARING-SINGAPORE (PTE)LTD.

INA SN68 needle roller bearings

Bearing No. SN68



SN68 Bearing 2D drawings and 3D CAD models

Size	9.525x14.288x12.7 mm
Bore Diameter	9,525 mm
Outer Diameter	14,288 mm
Width	12,7 mm
Fw	9,525 mm
D	14,288 mm
C	12,7 mm
Weight	0,007 Kg
Basic dynamic load rating (C)	7,7 kN
Basic static load rating (C0)	7,7 kN