

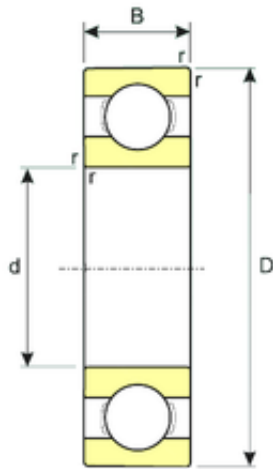

BEARING-SINGAPORE (PTE)LTD.



4,762 mm x 12,7 mm x 3,967 mm ISB R3 deep groove ball bearings

Bearing No. R3

Size	4.762x12.7x3.967 mm
Bore Diameter	4,762 mm
Outer Diameter	12,7 mm
Width	3,967 mm
d	4,762 mm
D	12,7 mm
B	3,967 mm
C	3,967 mm
r min.	0,3 mm
Basic dynamic load rating (C)	1,01 kN

R3 Bearing 2D drawings and 3D CAD models