

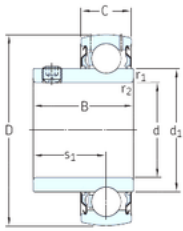

BEARING-SINGAPORE (PTE)LTD.

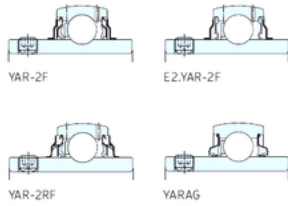

YAT



33,338 mm x 72 mm x 42,9 mm SKF
E2.YAR207-105-2F deep groove ball bearings

Bearing No. E2.YAR207-105-2F

E2.YAR207-105-2F Bearing 2D drawings and 3D CAD models

Size	33.338x72x42.9 mm
Bore Diameter	33,338 mm
Outer Diameter	72 mm
Width	42,9 mm
d	33,338 mm
D	72 mm
B	42,9 mm
C	19 mm
d1	46,1 mm
r1 min.	1 mm
r2 min.	1 mm
s1	25,4 mm
Weight	0,47 Kg
Basic dynamic load rating (C)	25,5 kN
Basic static load rating (C0)	15,3 kN
Fatigue load limit (Pu)	0,655